



Colorado College

The Center for Immersive Learning and Engaged Teaching & Tutt Library

Presented by Pfeiffer Partners March 25-27, 2015

TUTT LIBRARY

THE DESIGN PROCESS

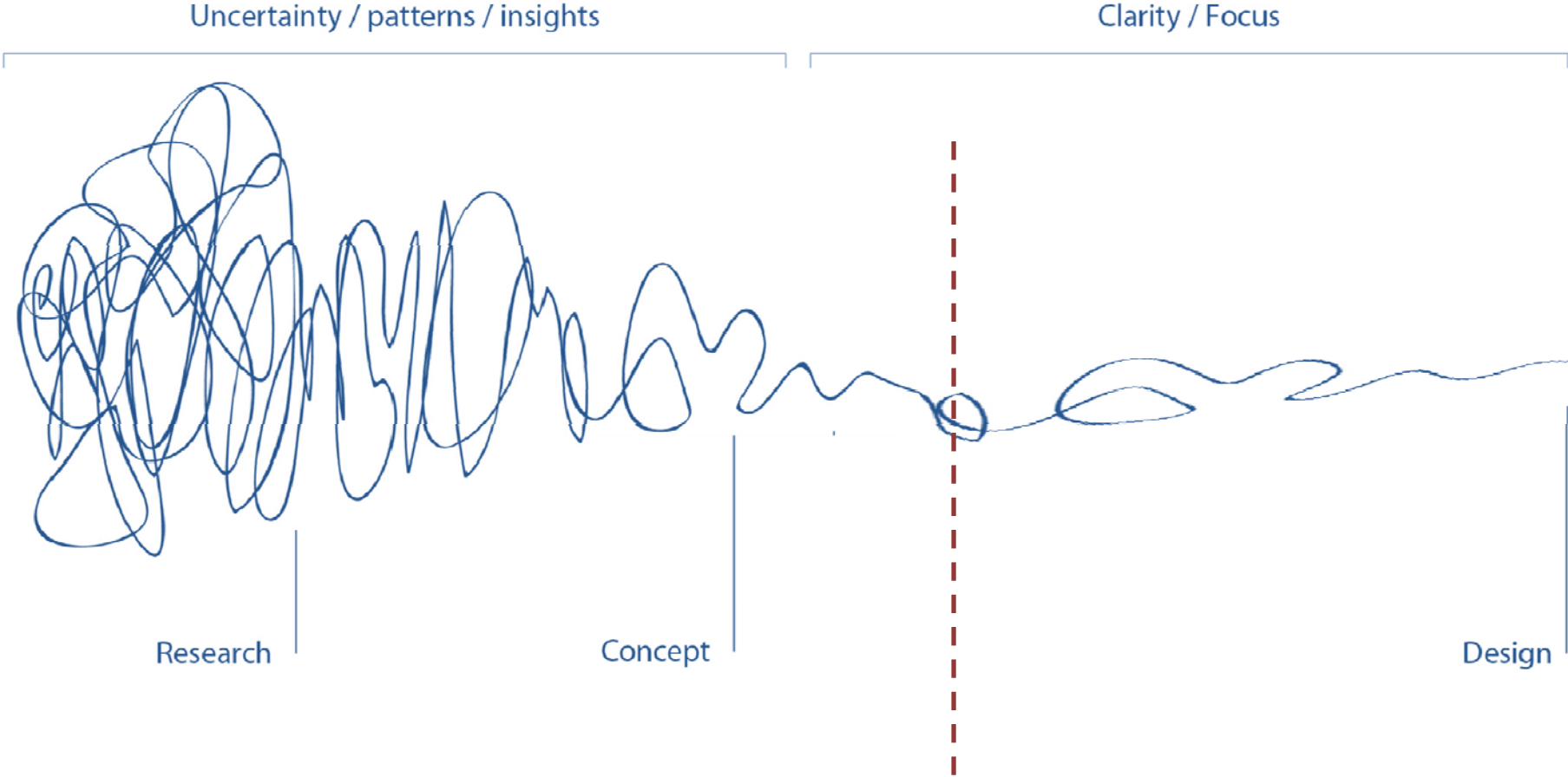

{ enhancing the vision }

vision =
program + concept

{ **defining** the moments }

moment

noun mo·ment \ 'mō-mənt \

1 *a* : a minute portion or point of time

b : a comparatively brief period of time

2 *a* : present time

b : a time of excellence or conspicuousness

3 : importance in influence or effect



COLORADO COLLEGE



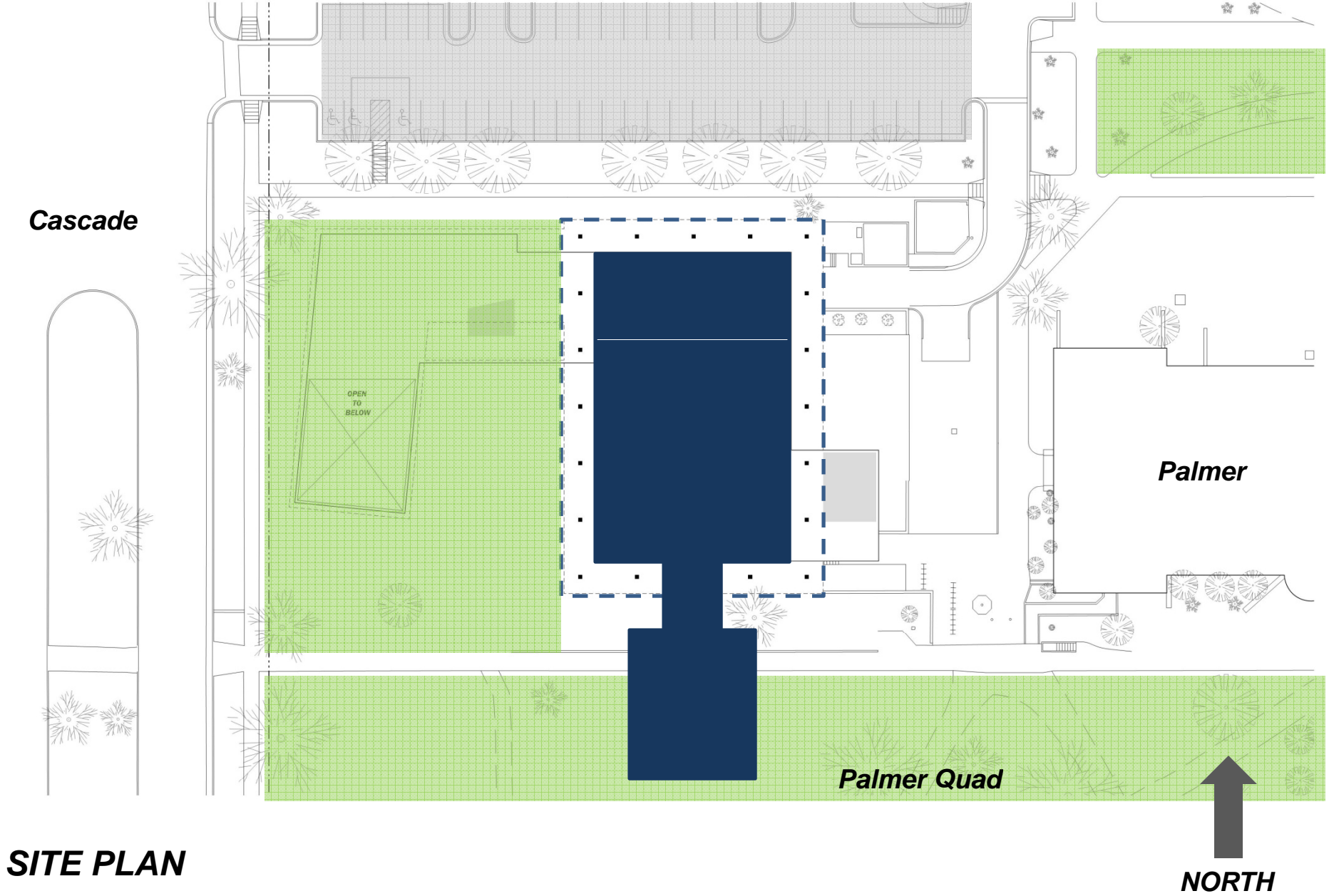

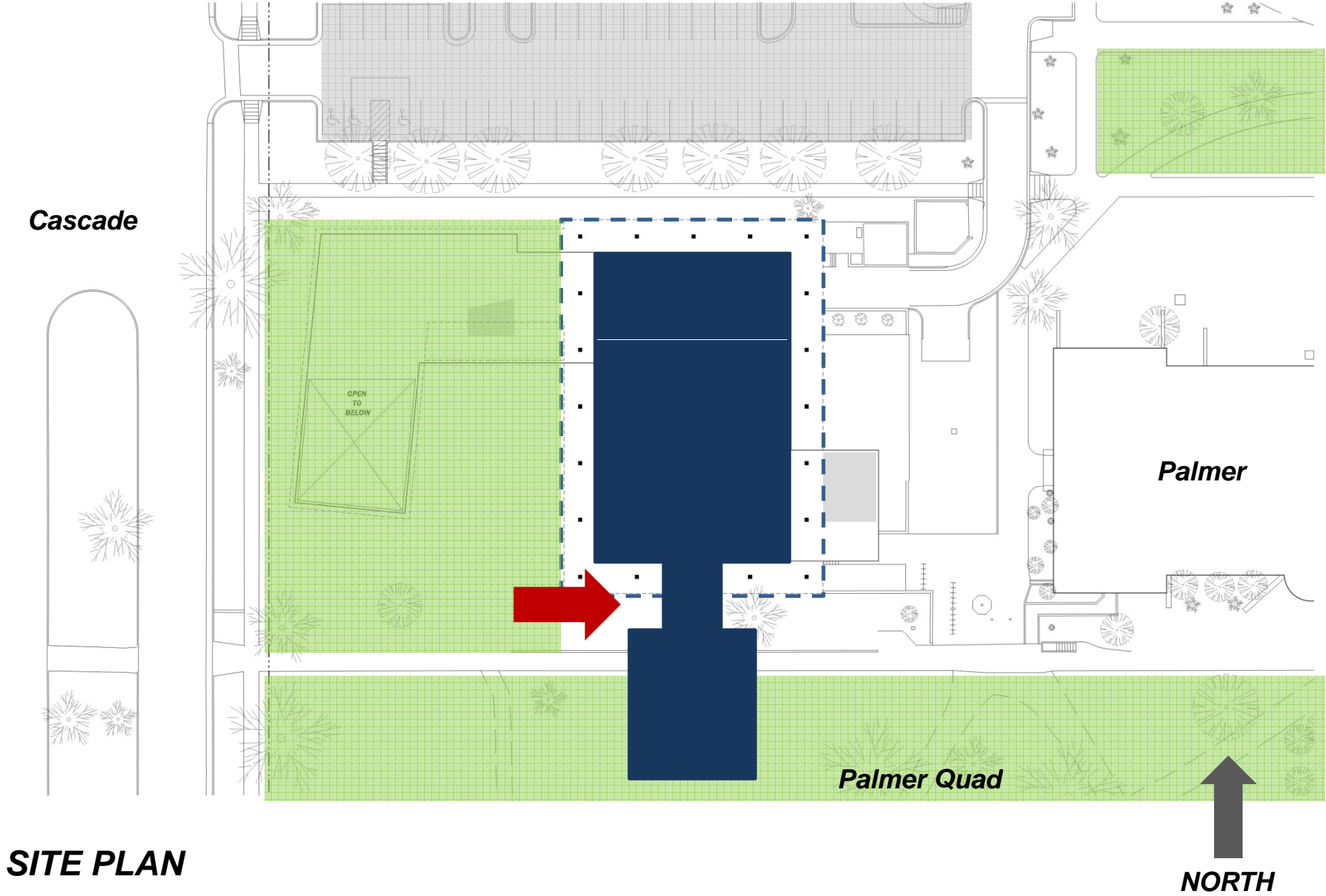

SITE PLAN

NORTH

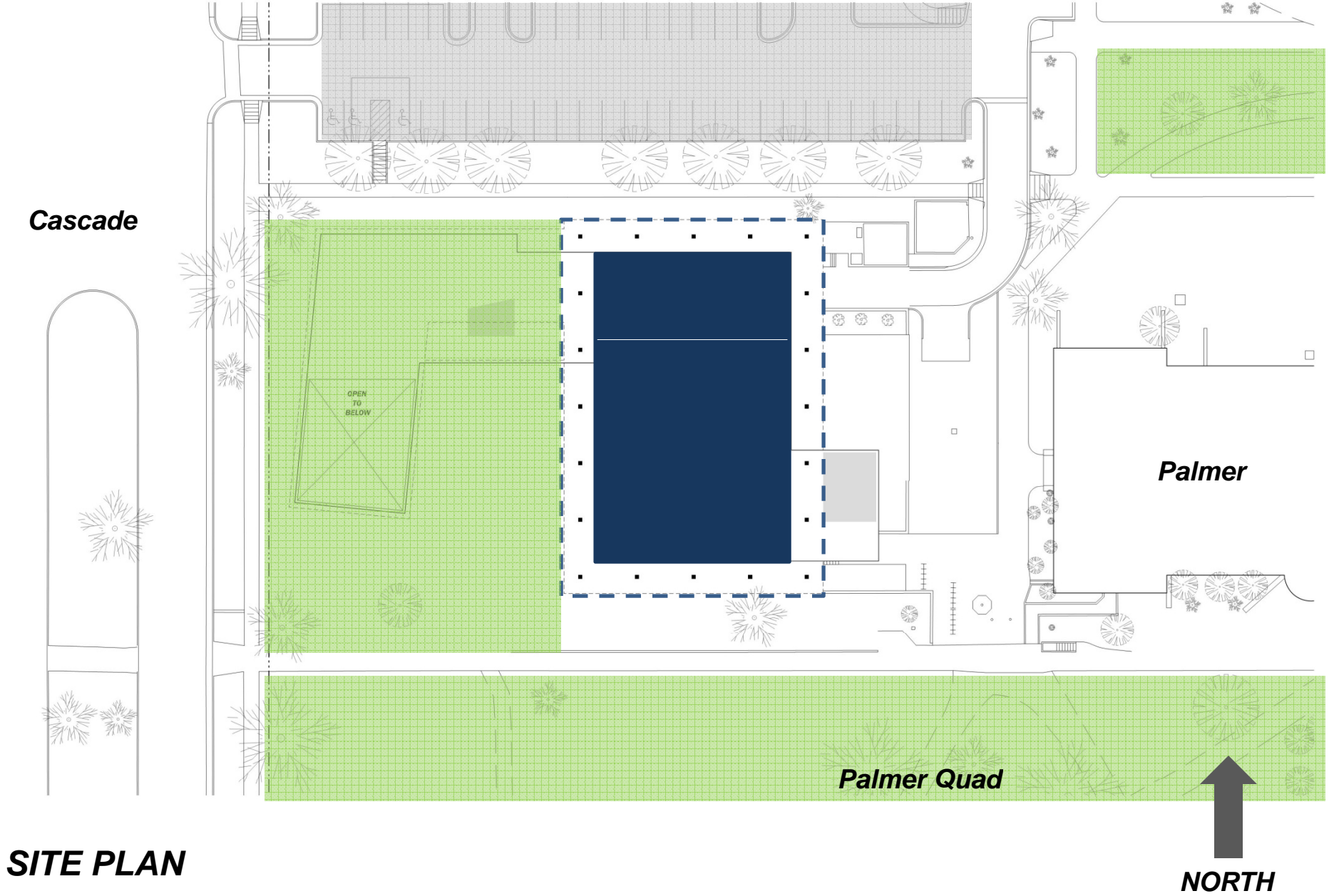

Cascade

Palmer

Palmer Quad

SITE PLAN

NORTH

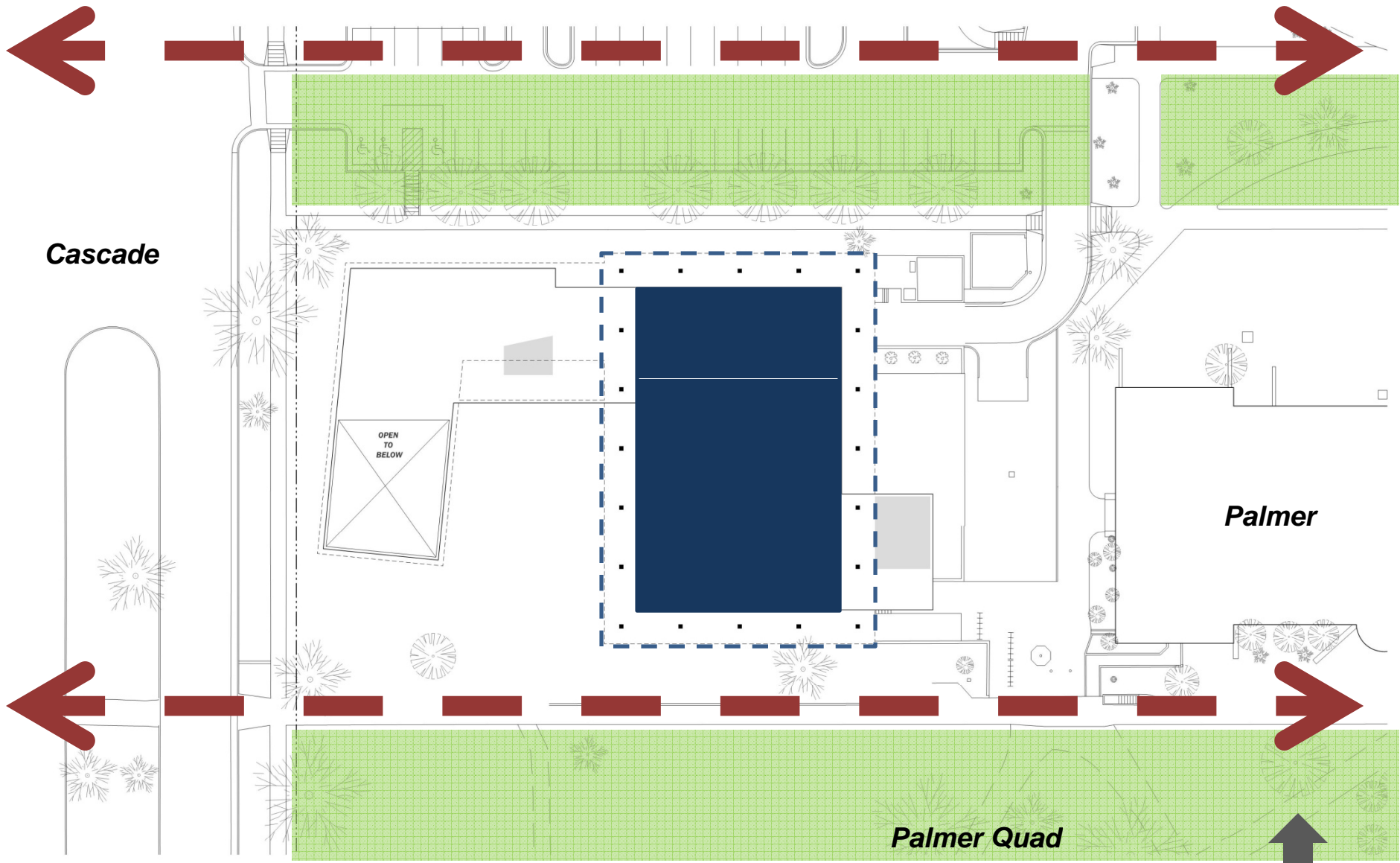

SITE PLAN

NORTH

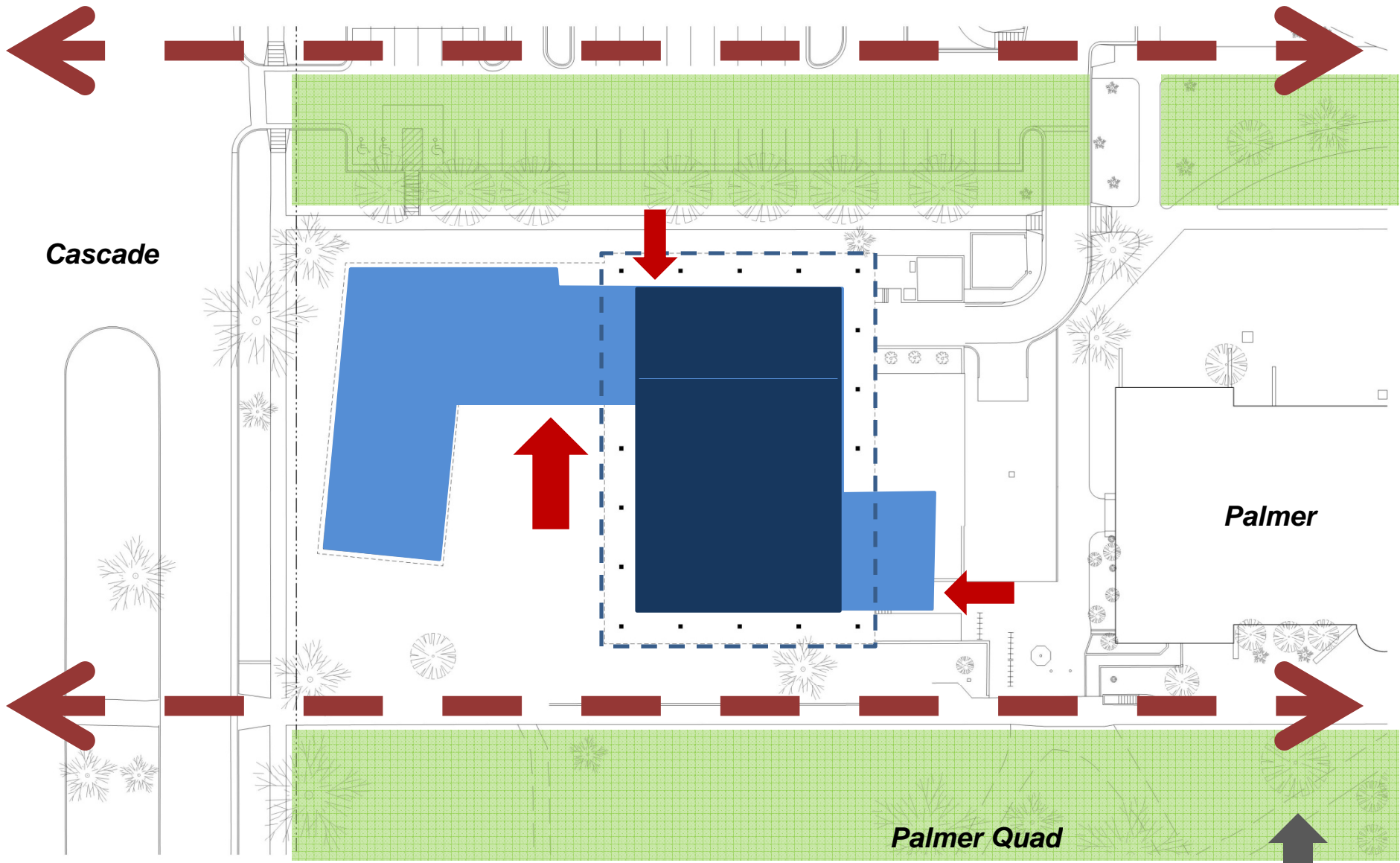

Cascade

Palmer

Palmer Quad

SITE PLAN

NORTH

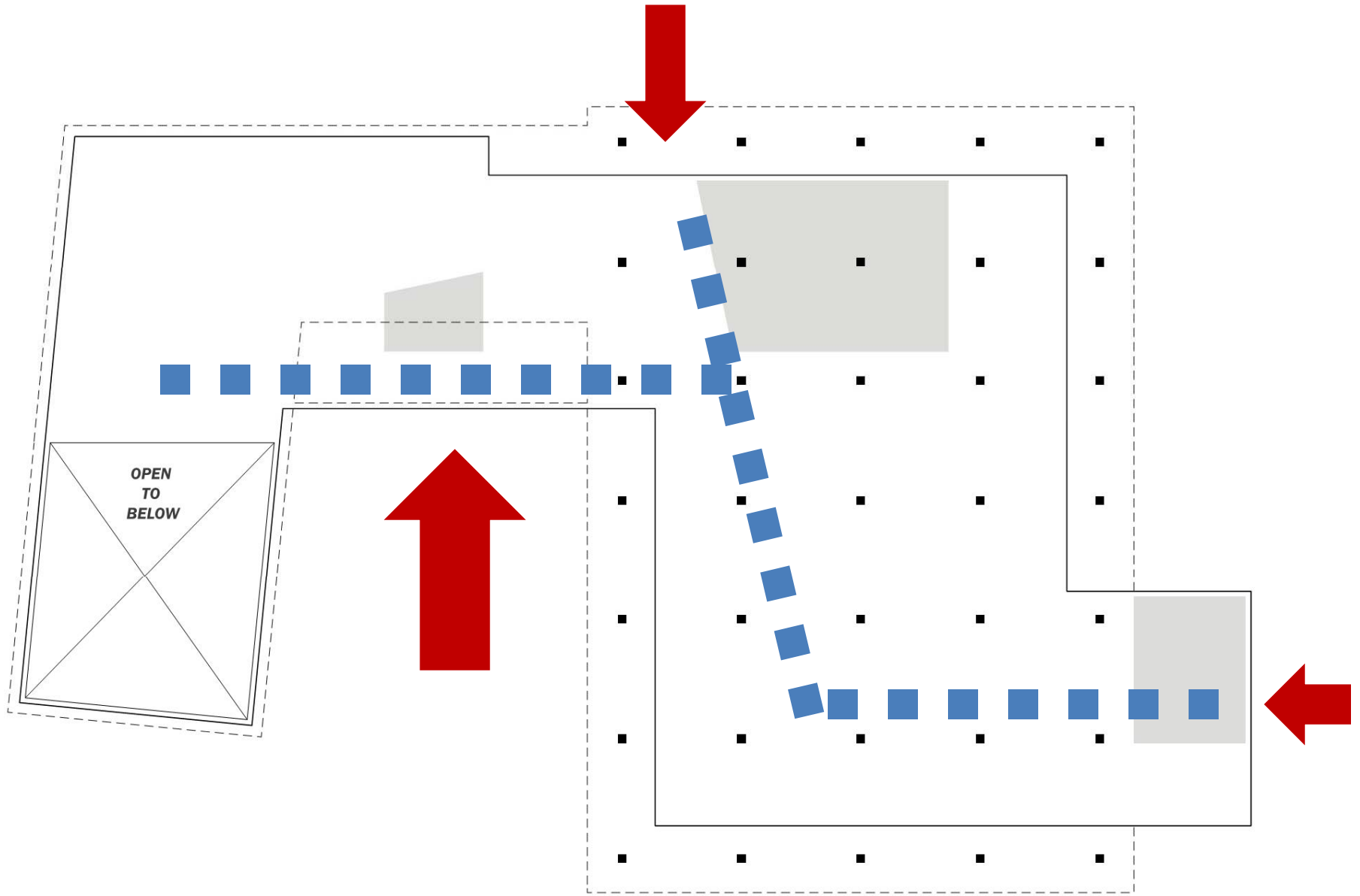

FIRST FLOOR

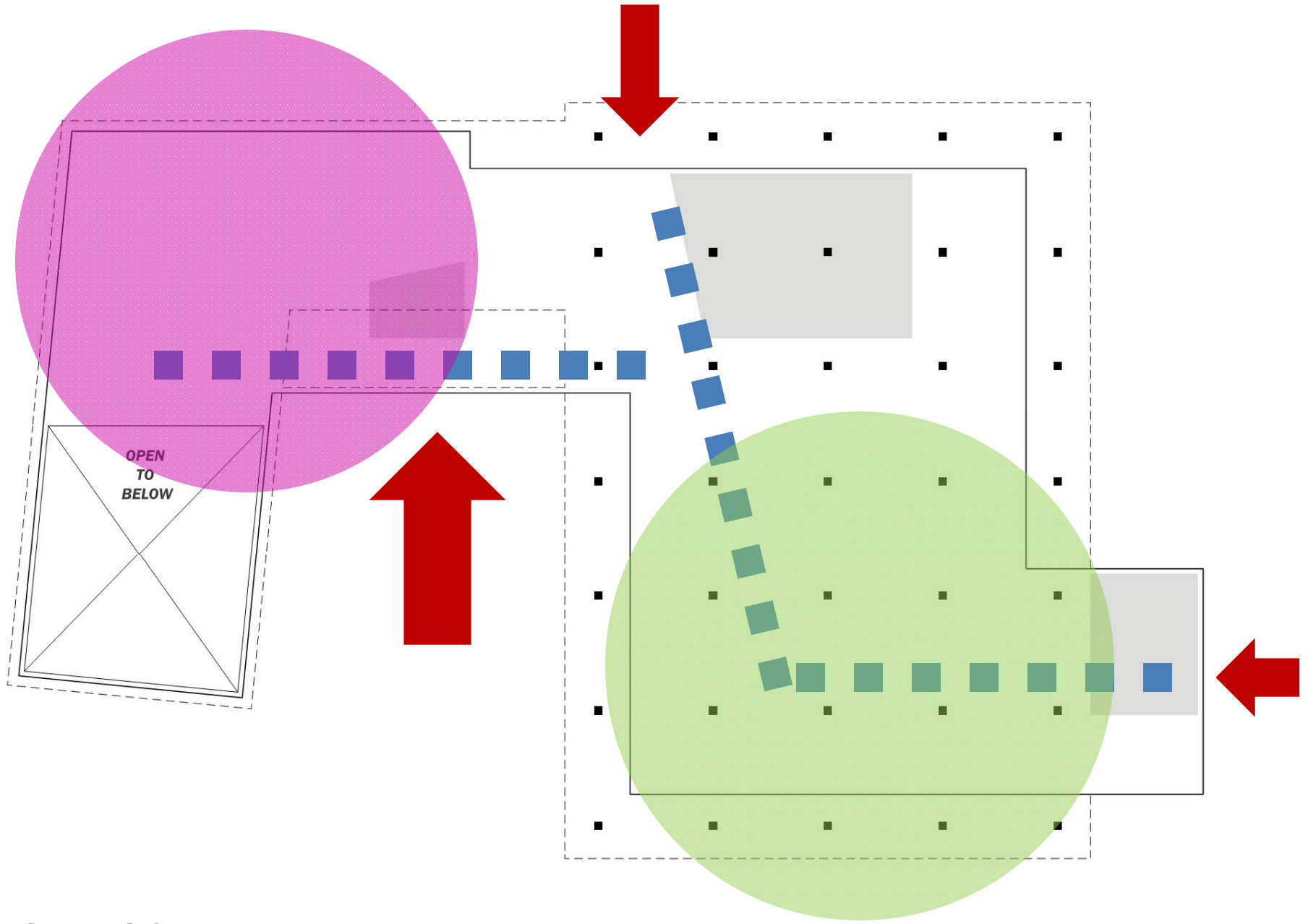

FIRST FLOOR

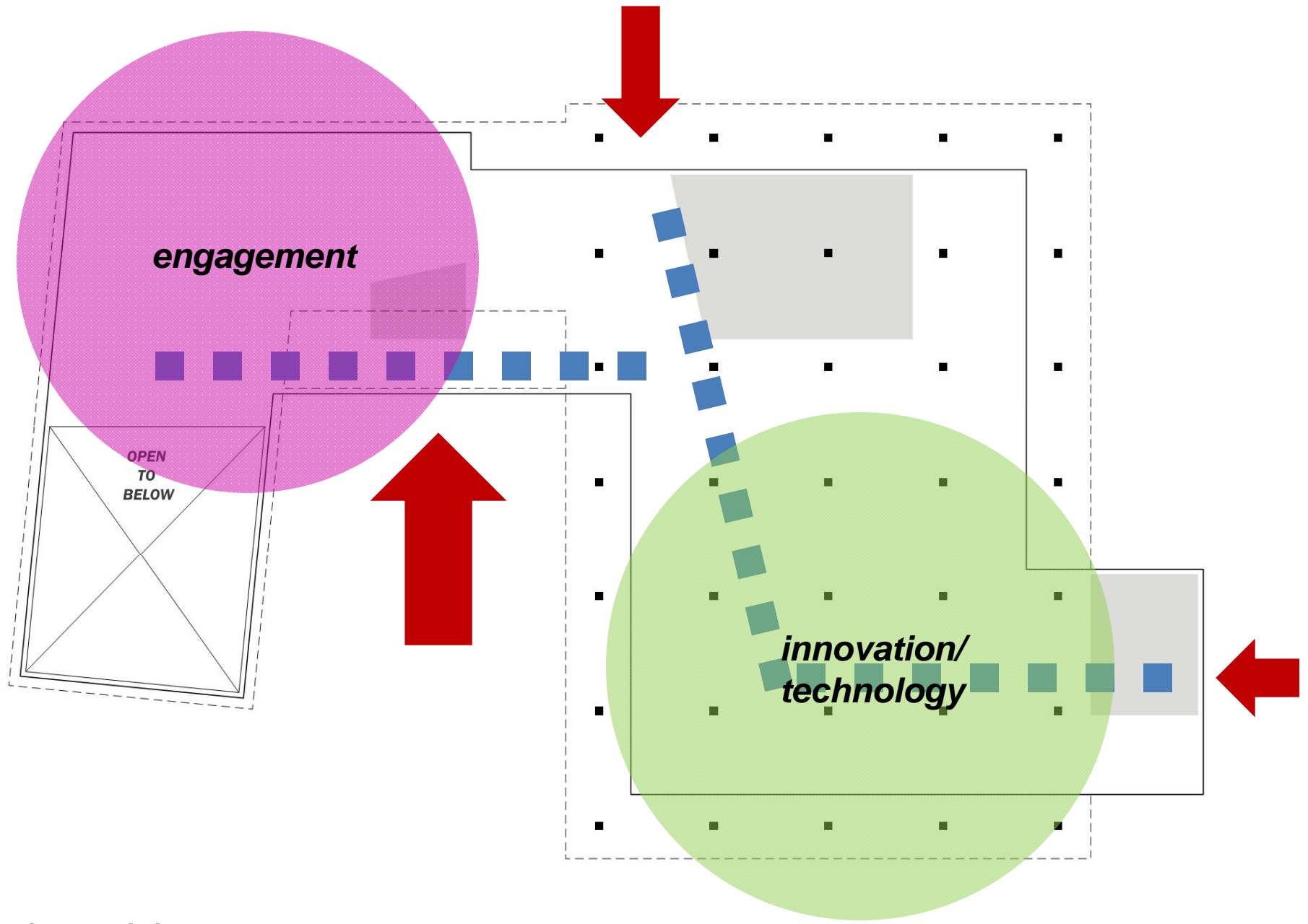

FIRST FLOOR

FYE
Field Study
International Programs
Sustainability Office
CCE
Instructional Support
Crown
Pedagogy Researcher

Access Services Group
Metadata/Systems ILS

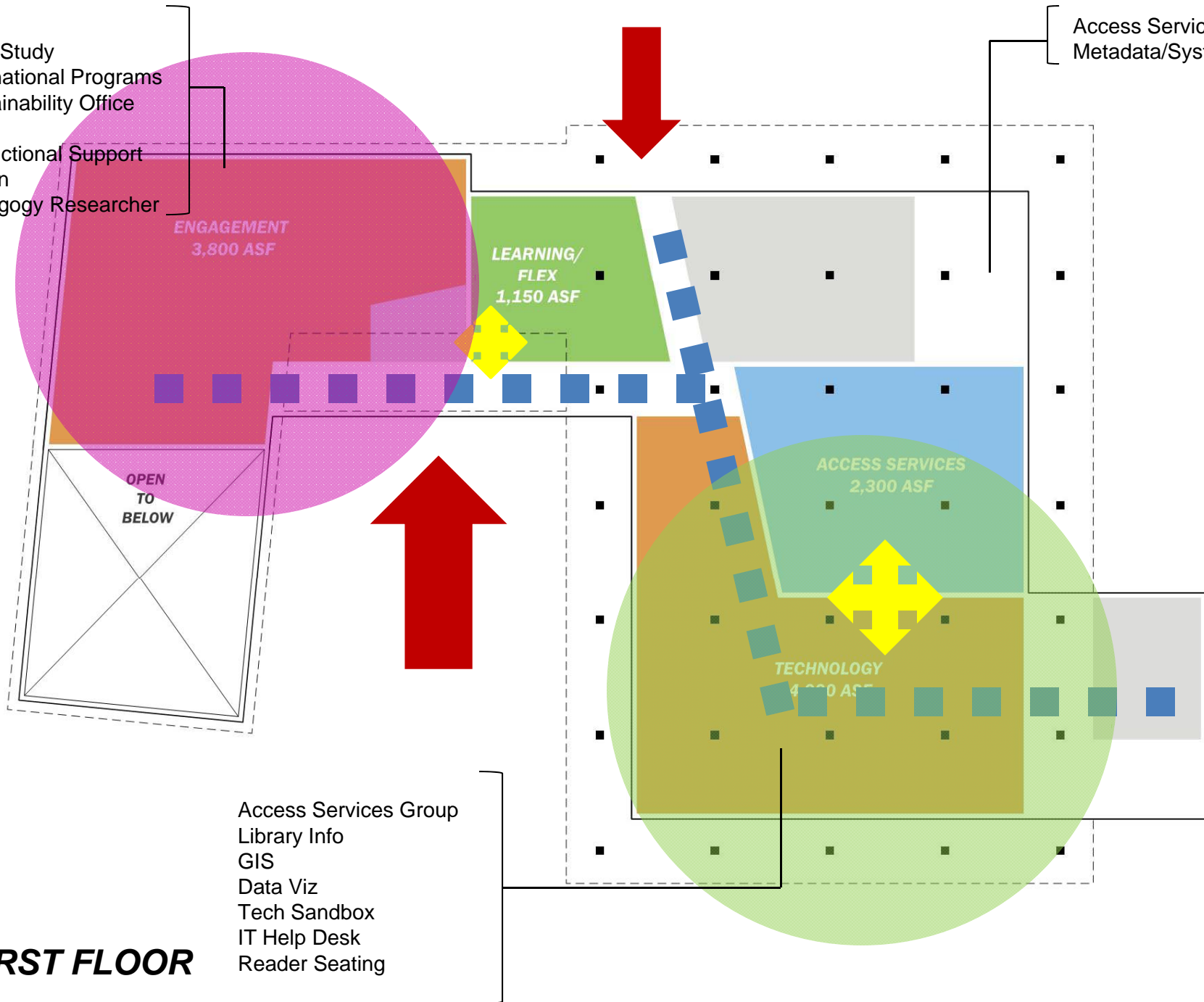

OPEN
TO
BELOW

ENGAGEMENT
3,800 ASF

LEARNING/
FLEX
1,150 ASF

ACCESS SERVICES
2,300 ASF

TECHNOLOGY
4,000 ASF

Access Services Group
Library Info
GIS
Data Viz
Tech Sandbox
IT Help Desk
Reader Seating

FIRST FLOOR



classrooms

study

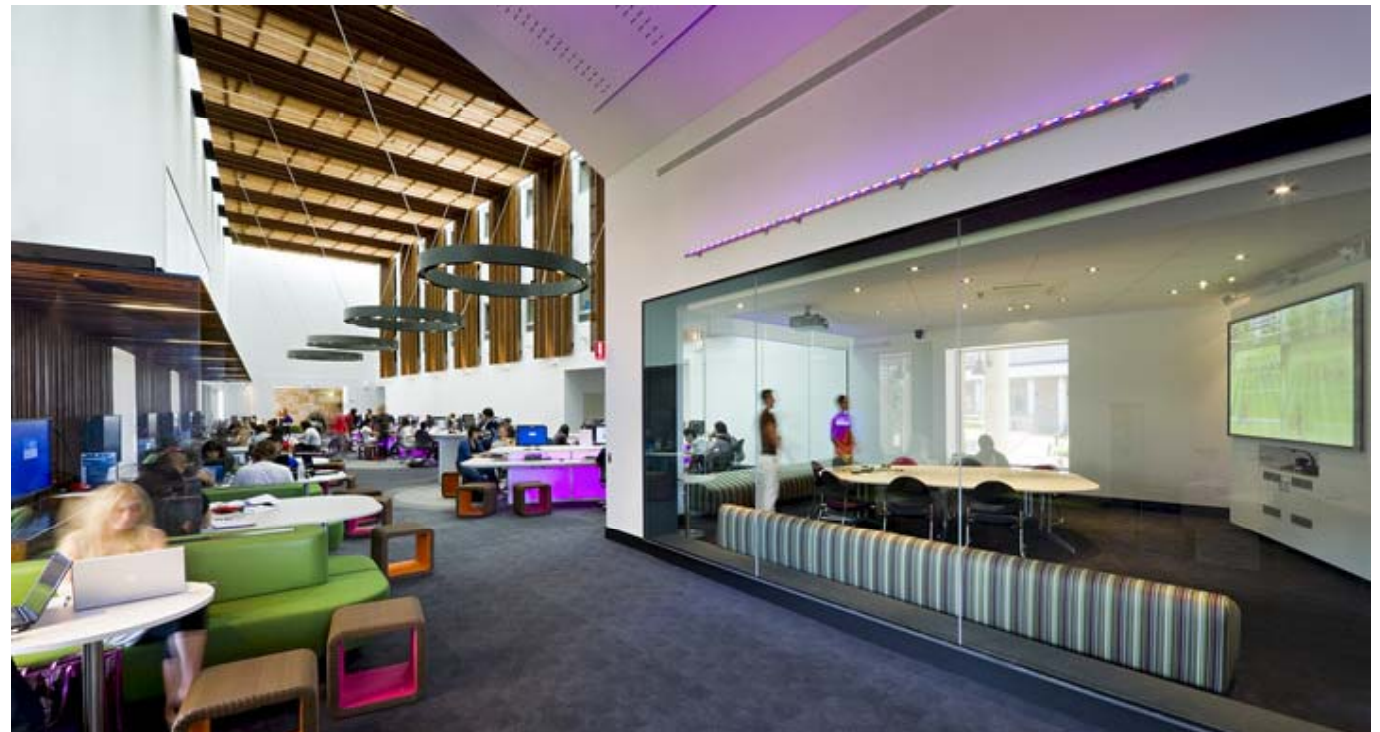

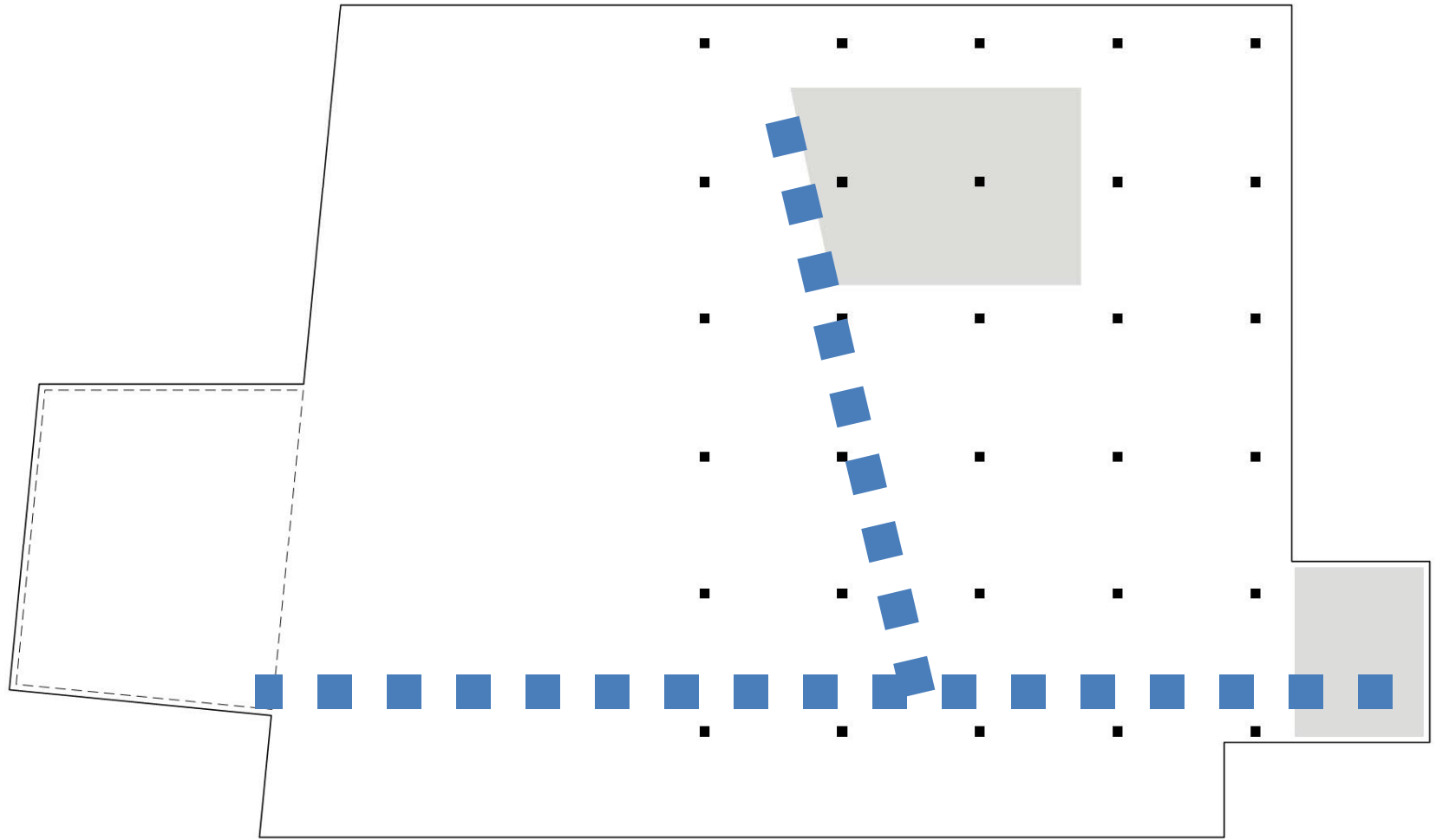

GARDEN LEVEL

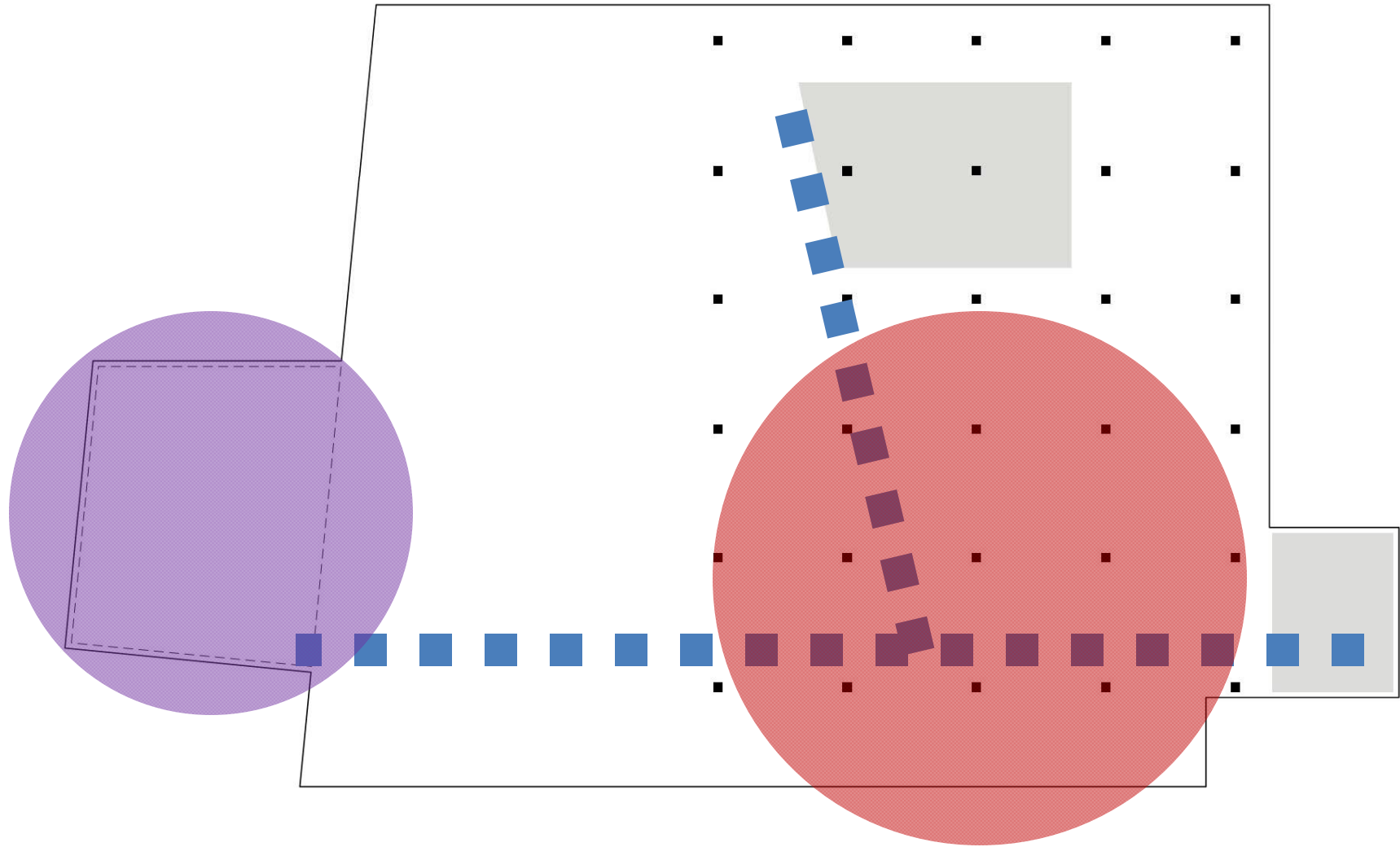

GARDEN LEVEL

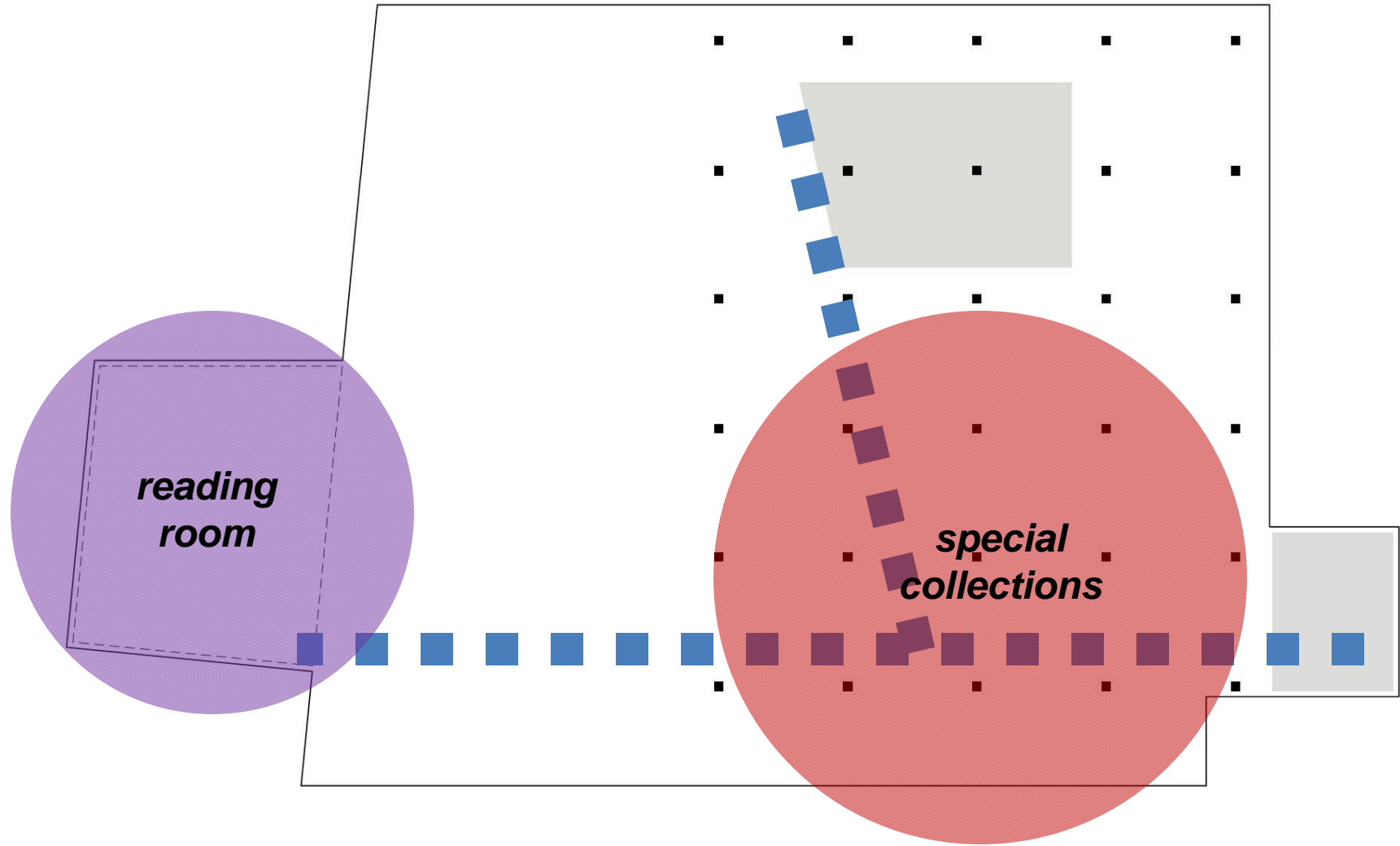

GARDEN LEVEL

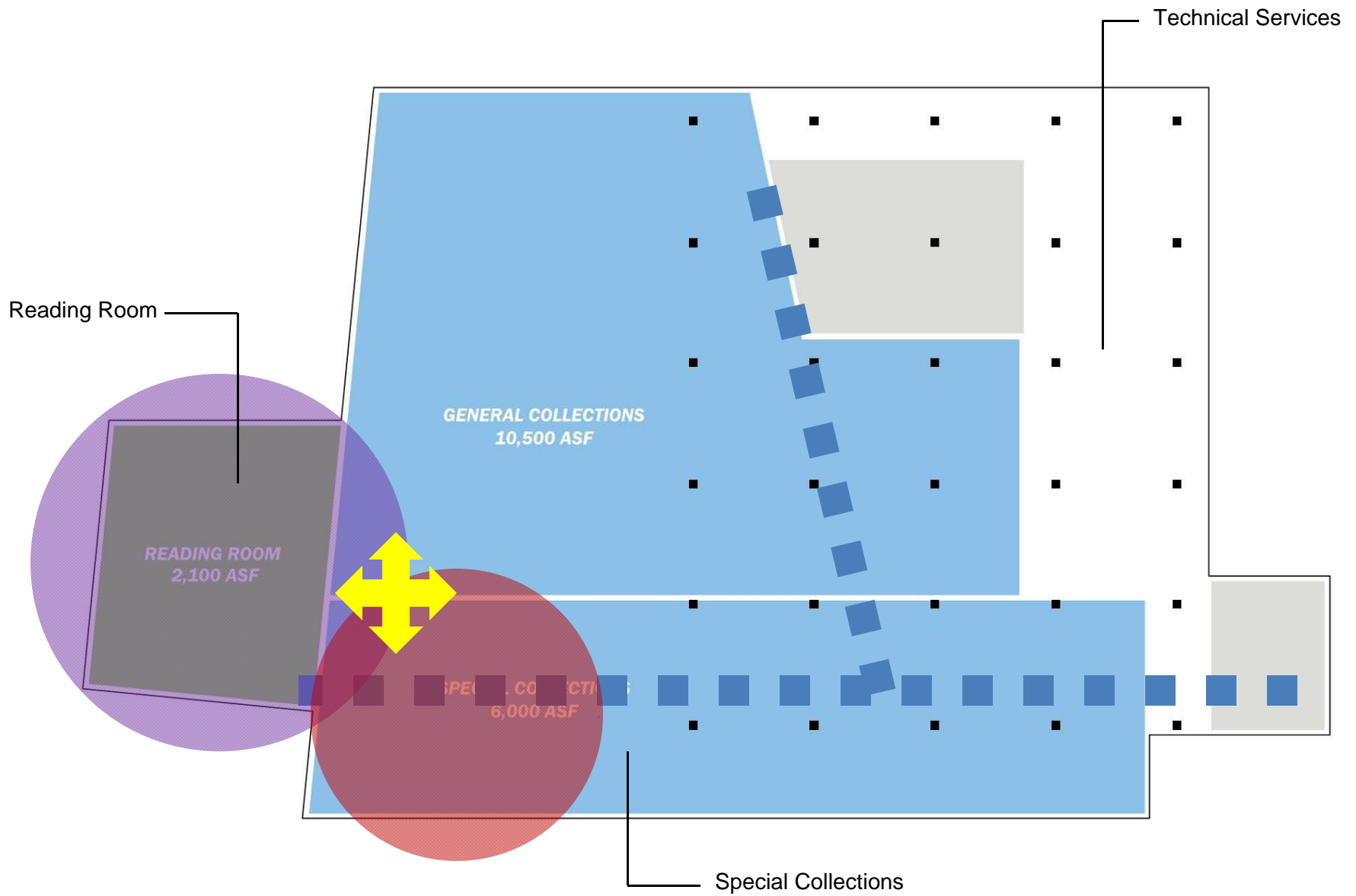

GARDEN LEVEL



reading room



special collections



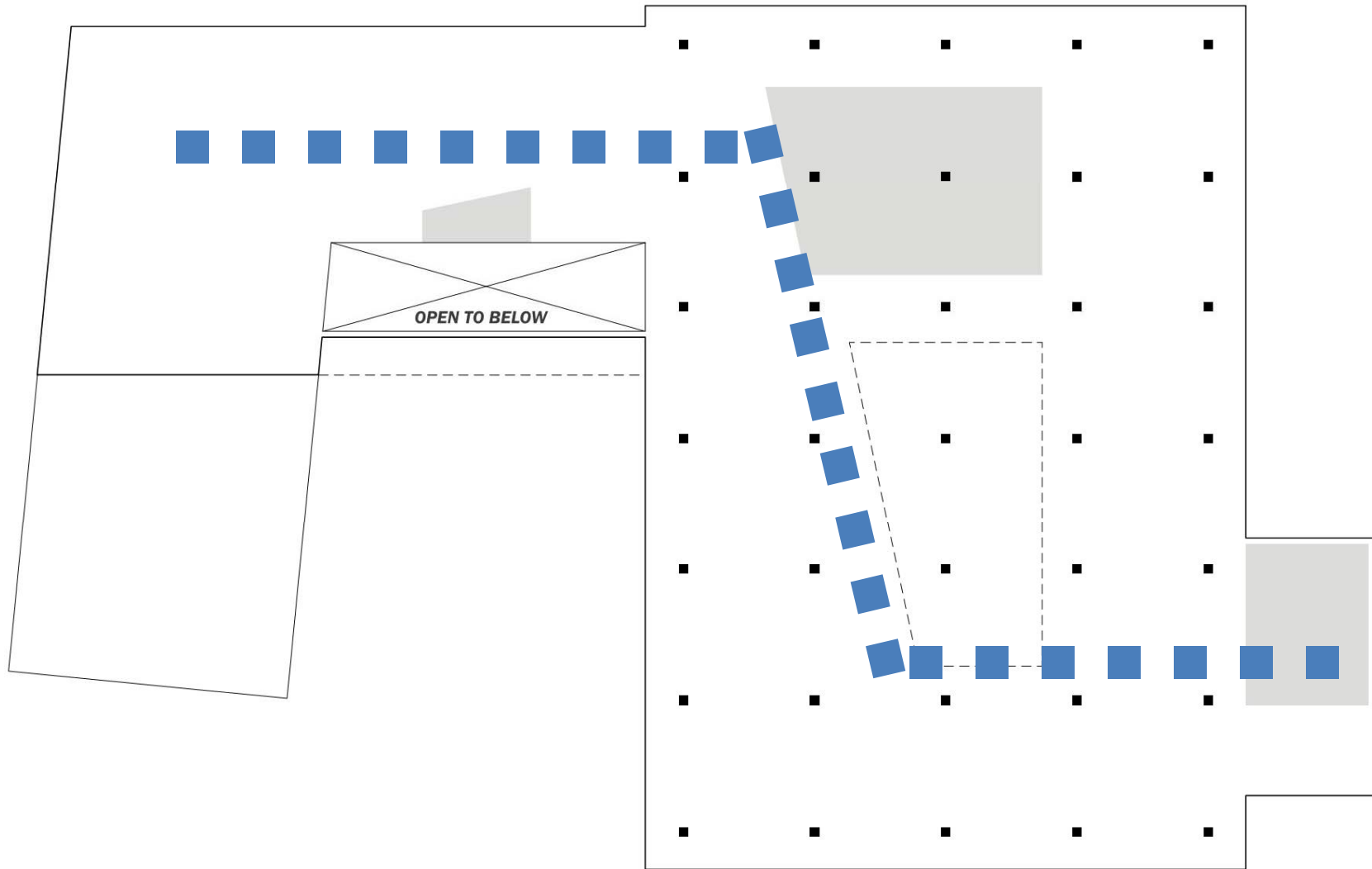

SECOND FLOOR

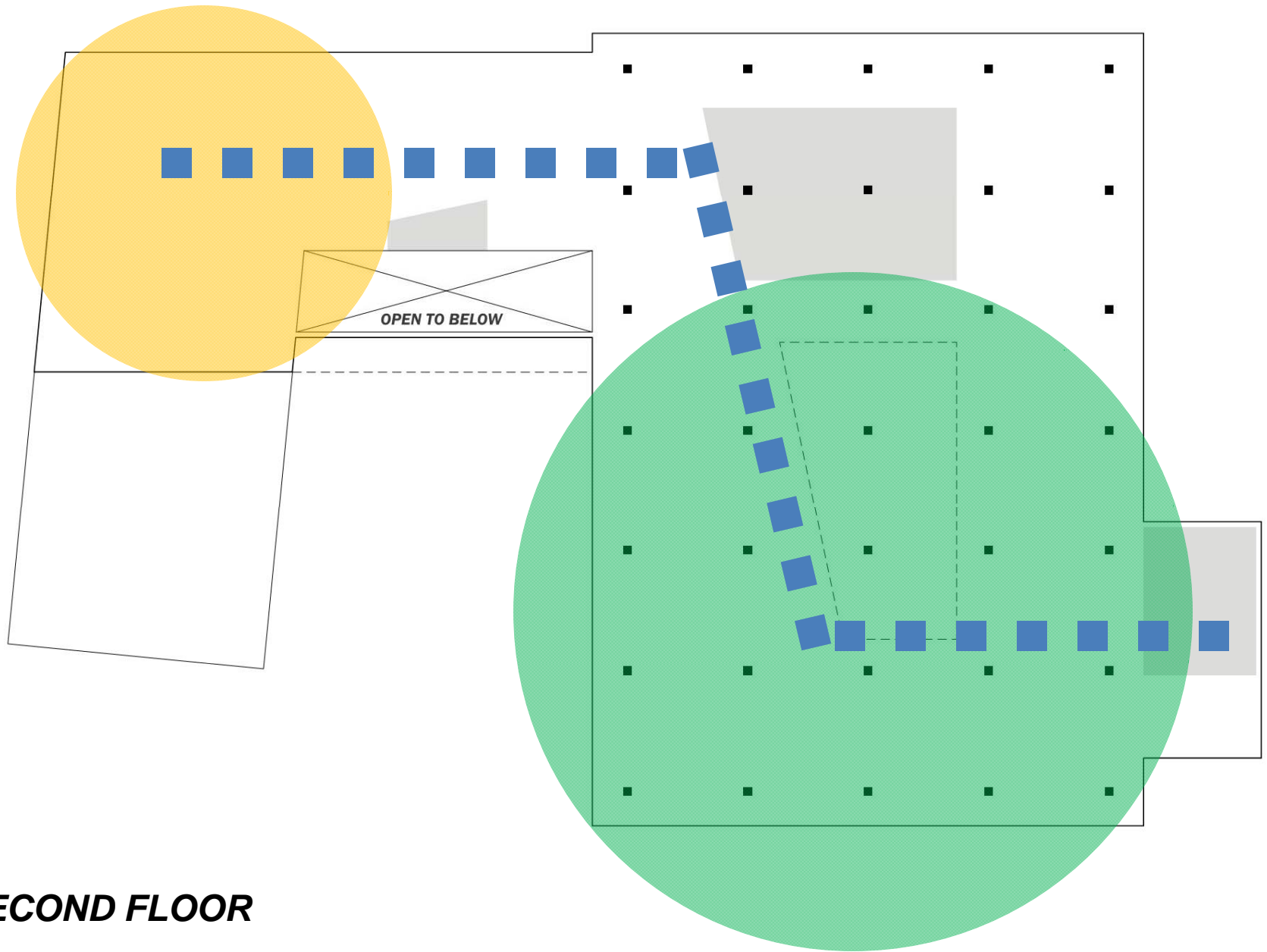

SECOND FLOOR

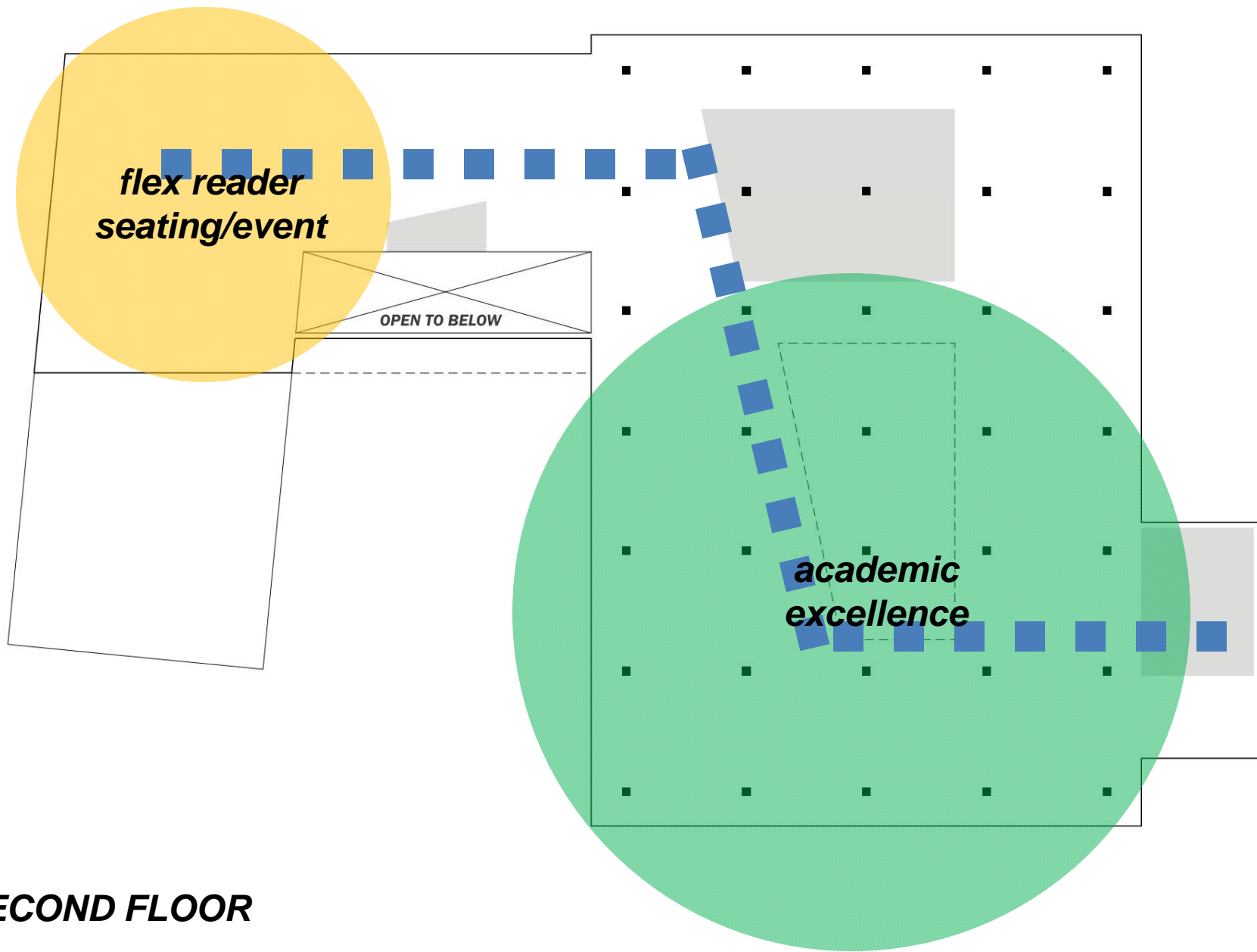

SECOND FLOOR

Reader Seating
Flex Event Space

Enclosed Study

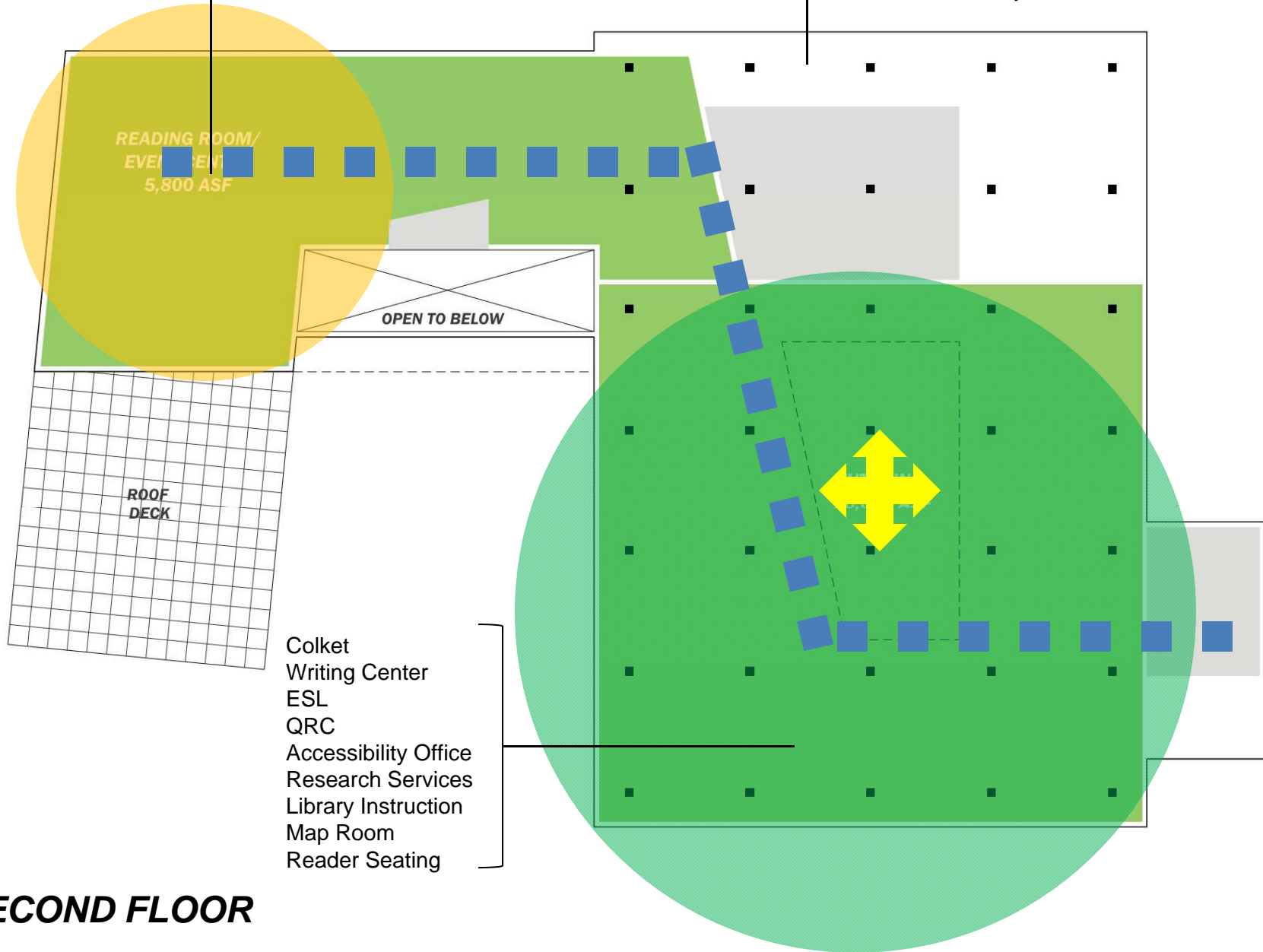

Colket
Writing Center
ESL
QRC
Accessibility Office
Research Services
Library Instruction
Map Room
Reader Seating

SECOND FLOOR



academic
excellence



study/event

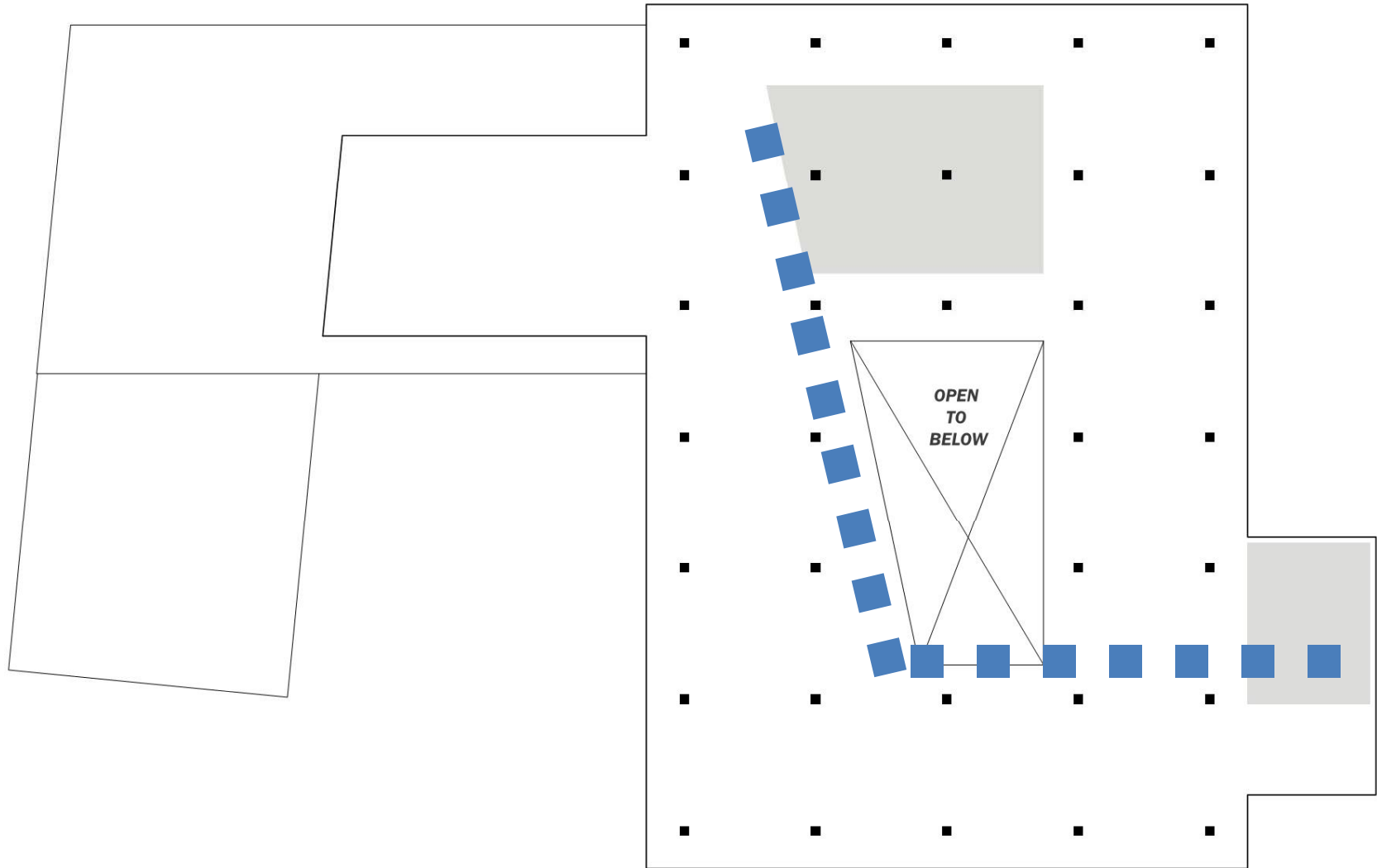

THIRD FLOOR

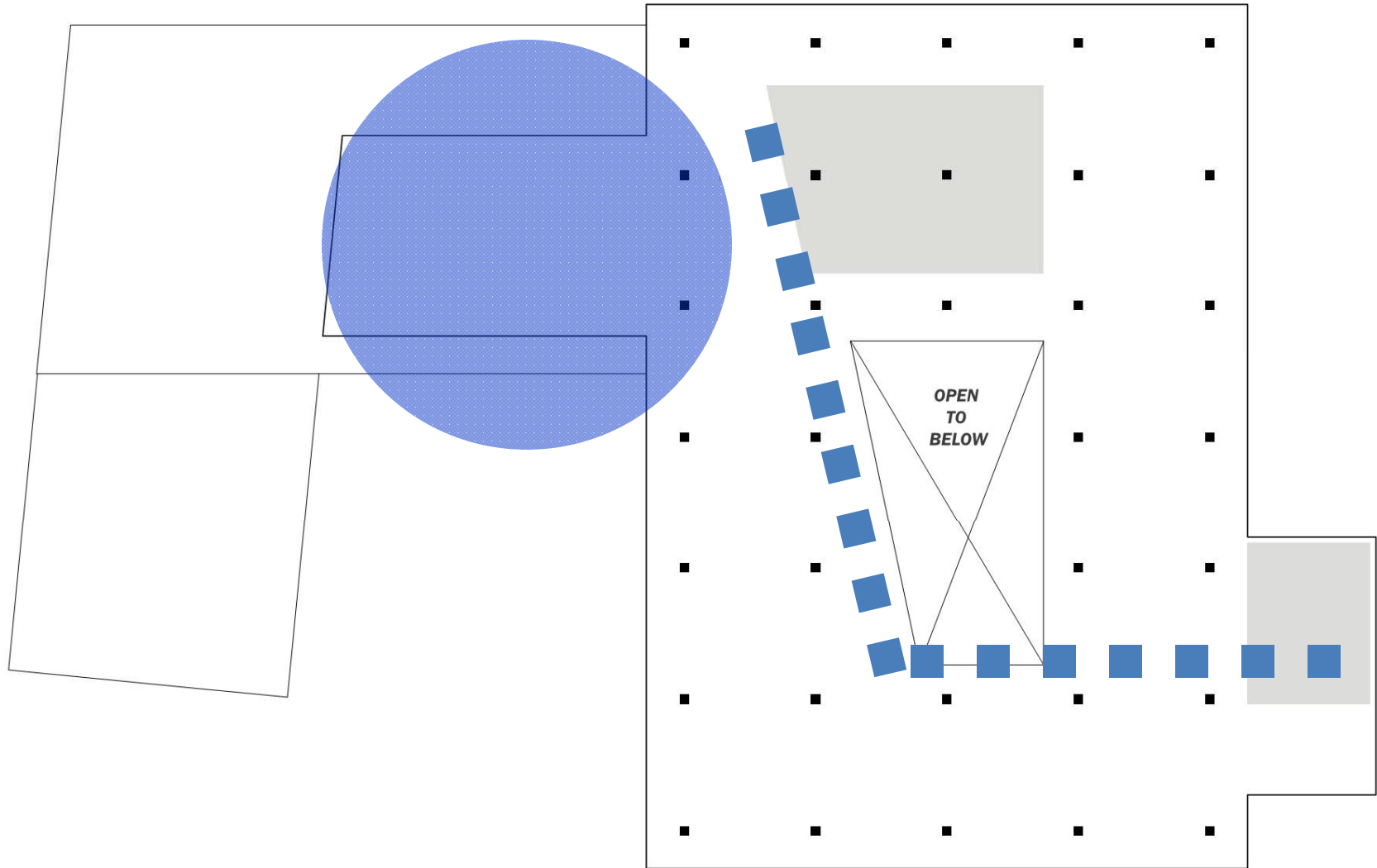

THIRD FLOOR

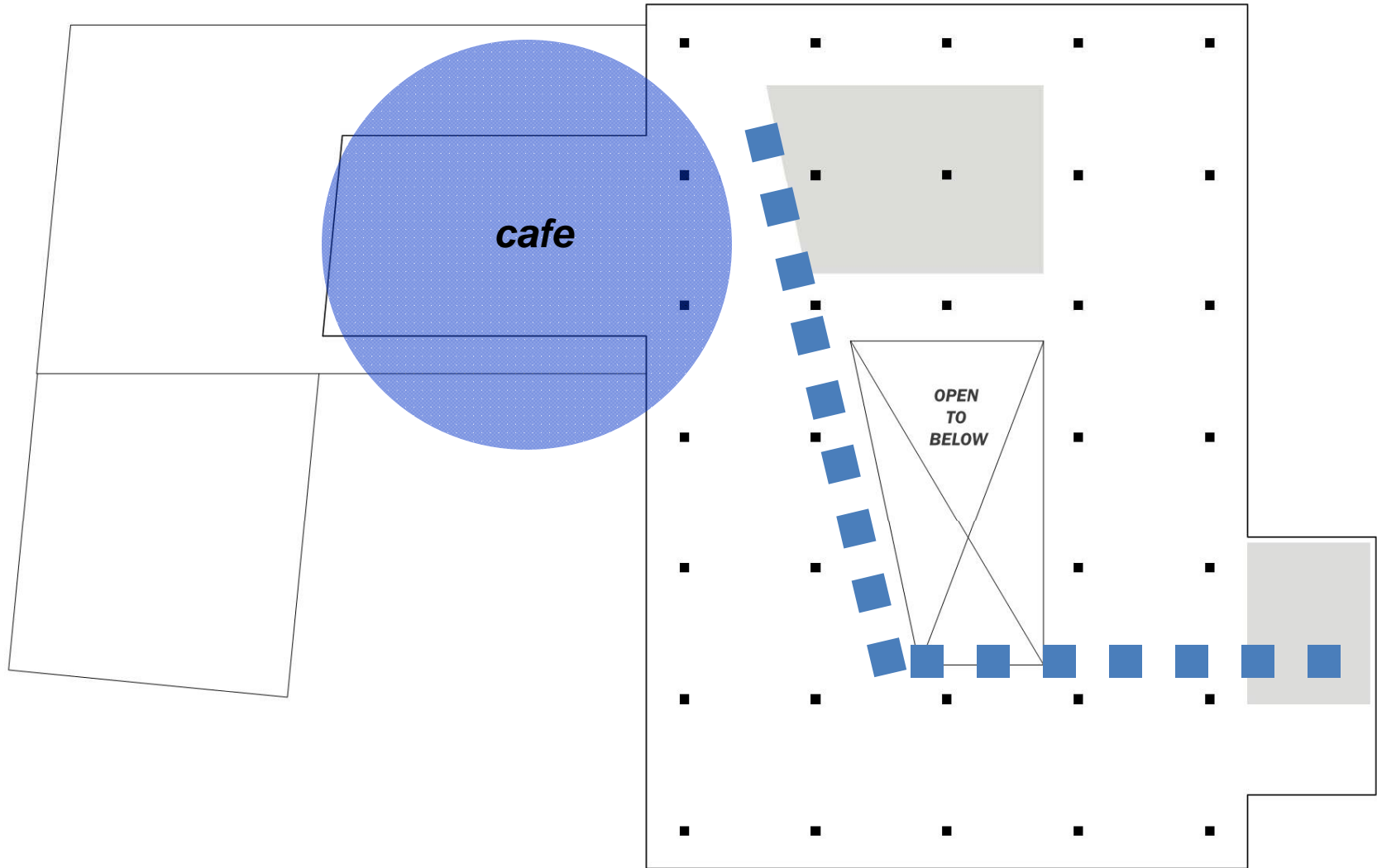

THIRD FLOOR

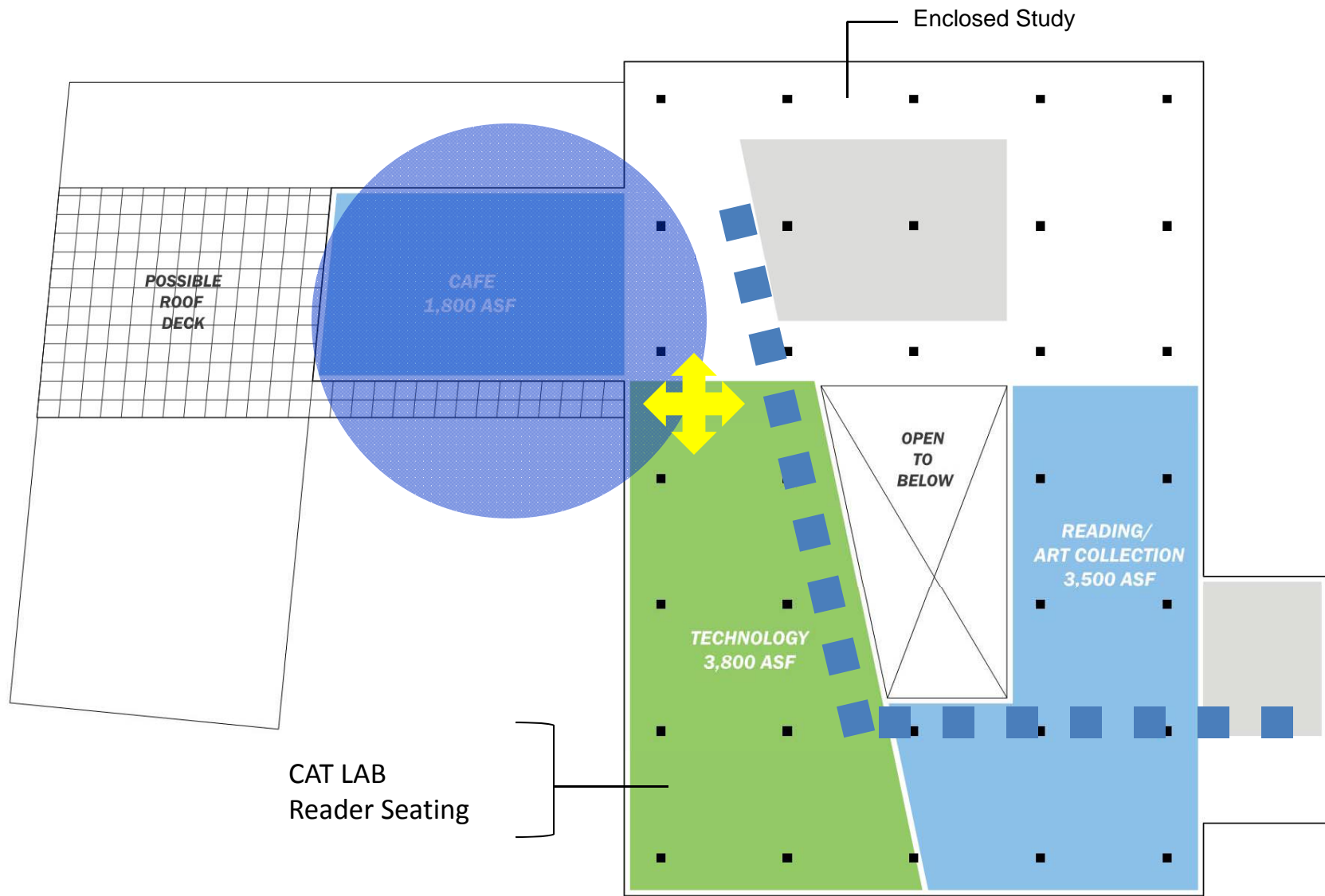

THIRD FLOOR

café/study

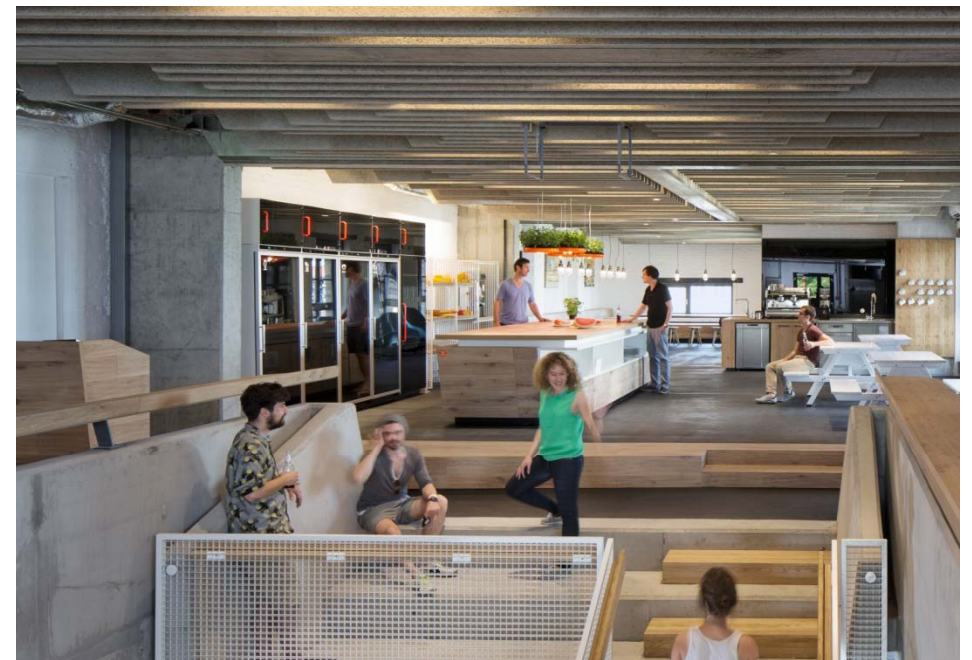

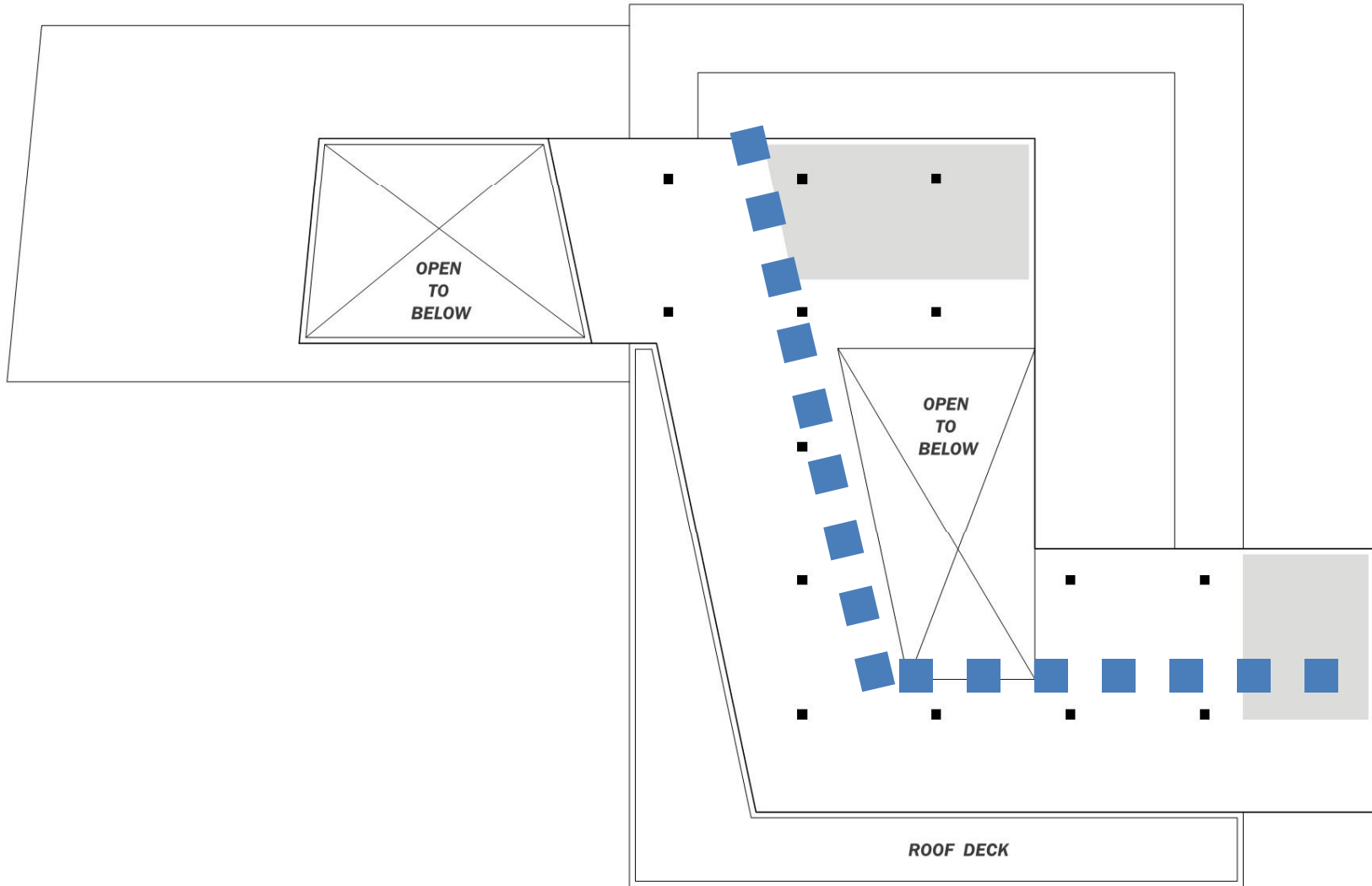

FOURTH FLOOR

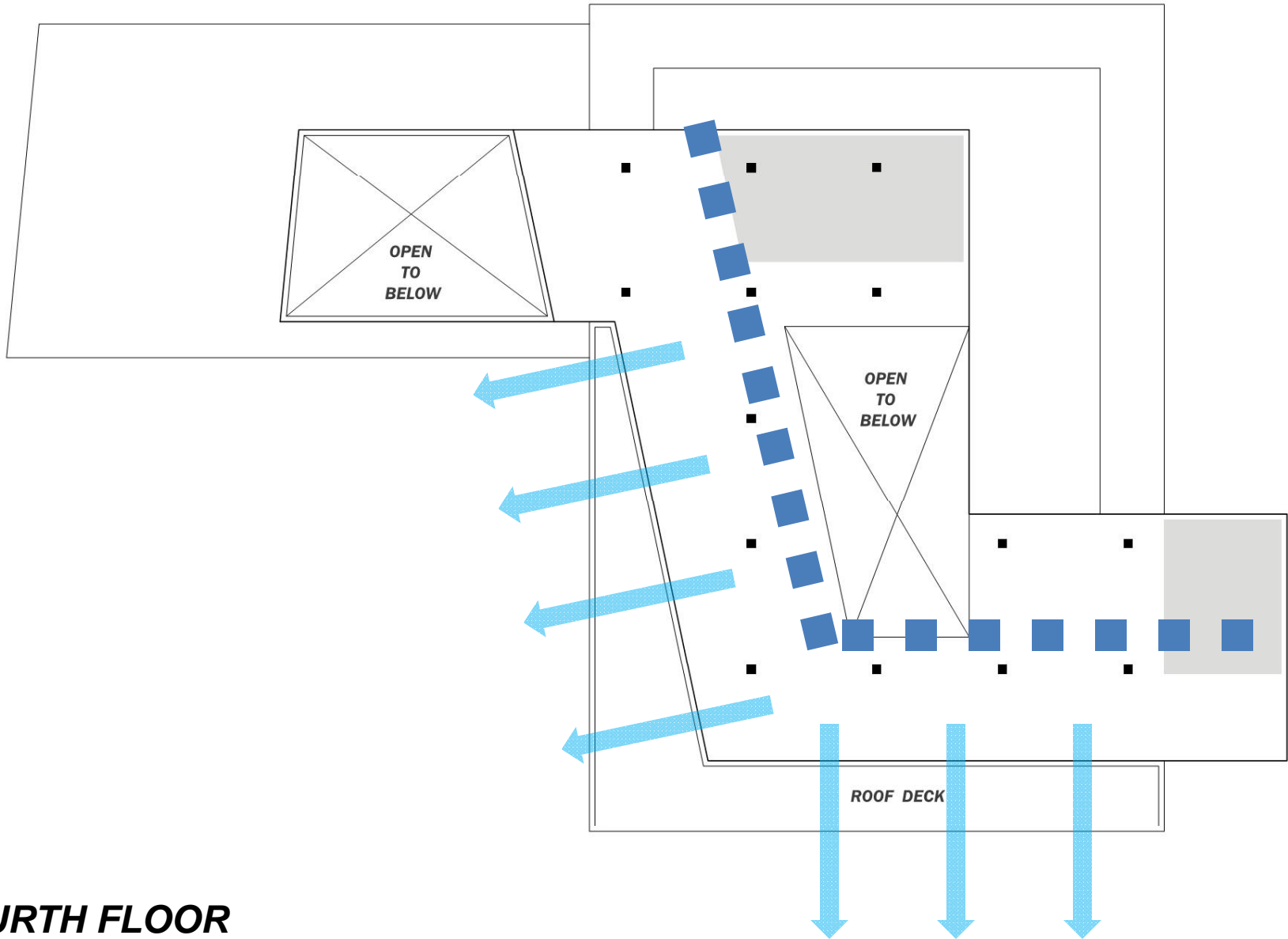

FOURTH FLOOR

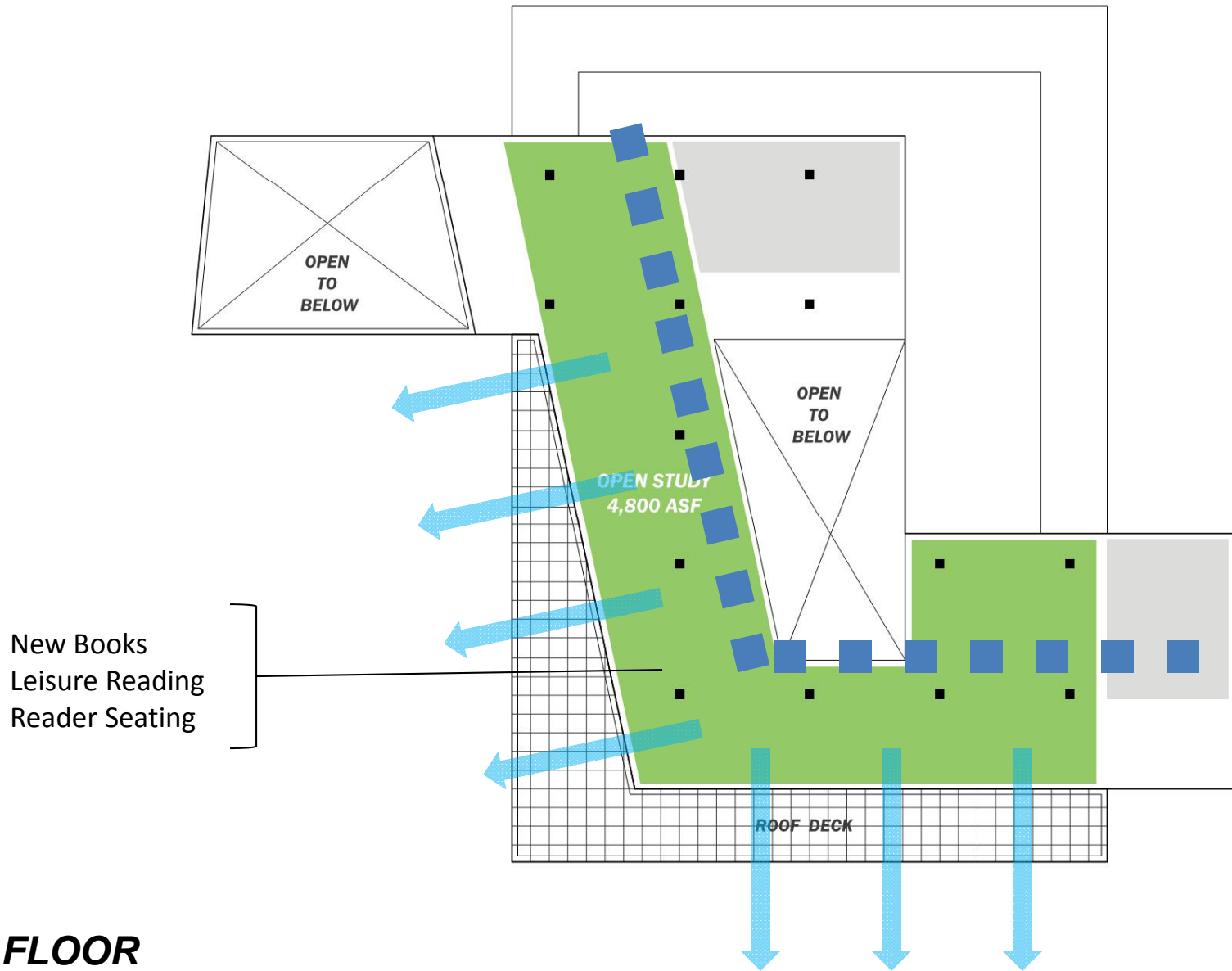

FOURTH FLOOR



connection to place





view from southwest

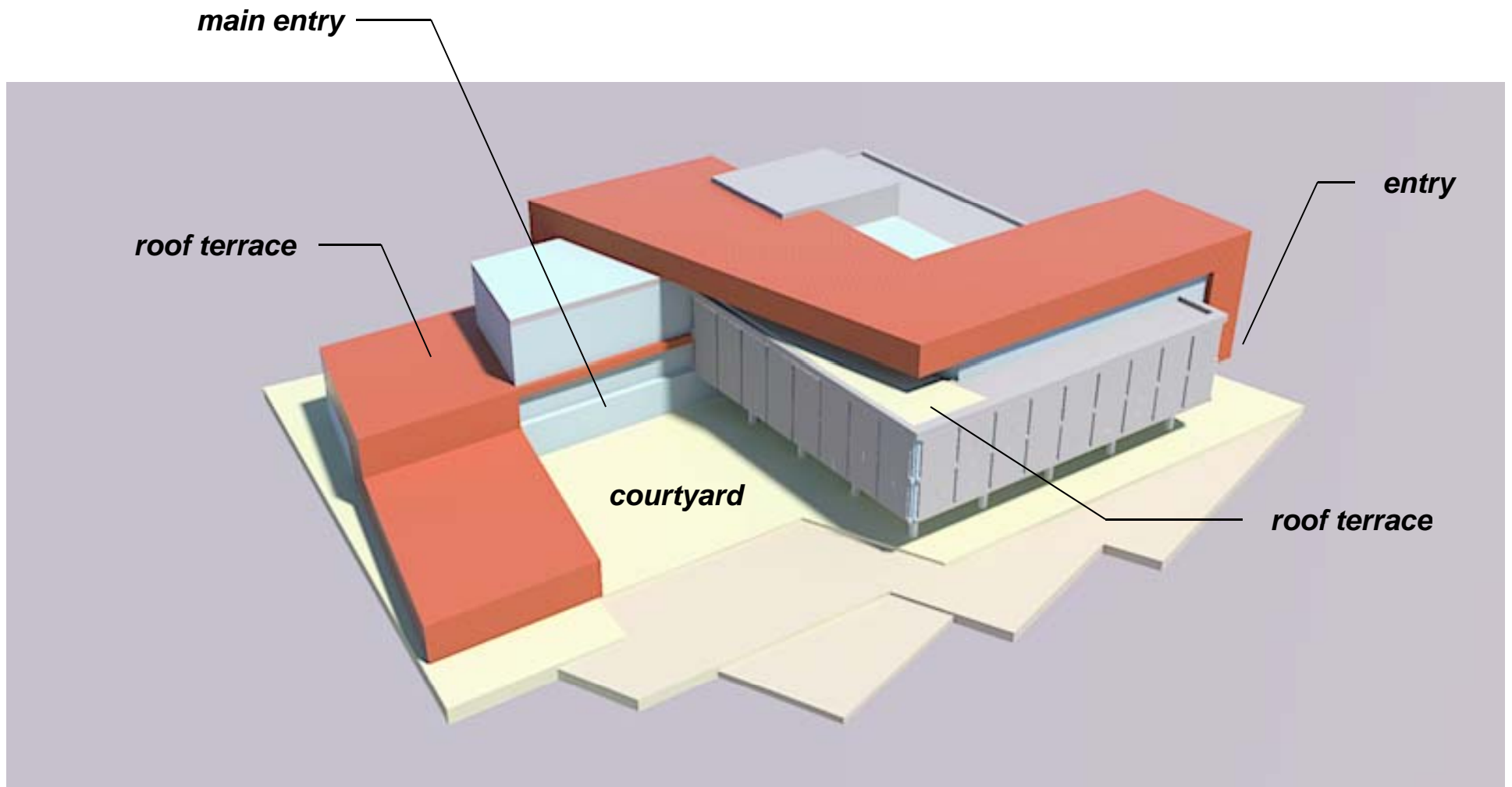

view from southwest

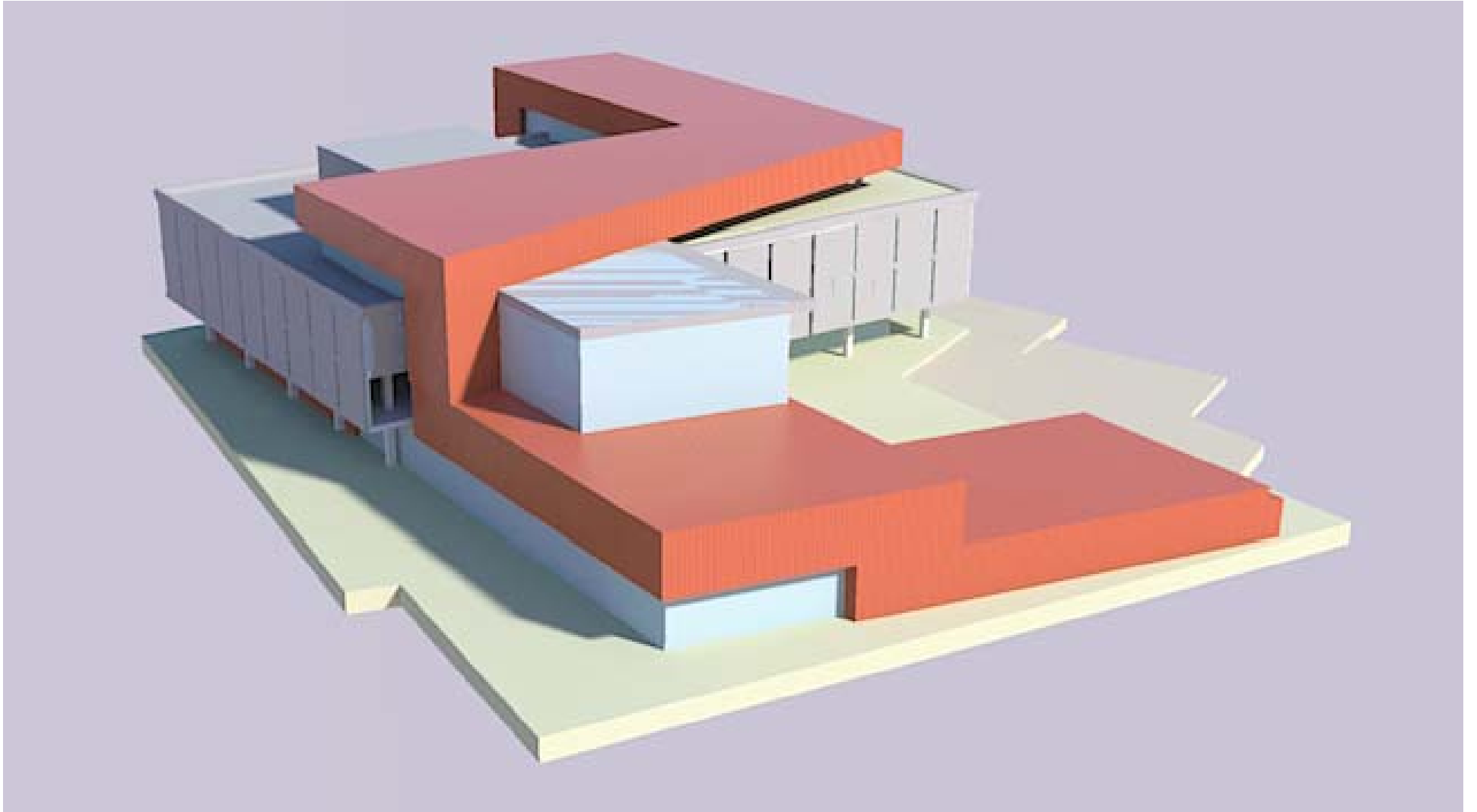

view from northwest

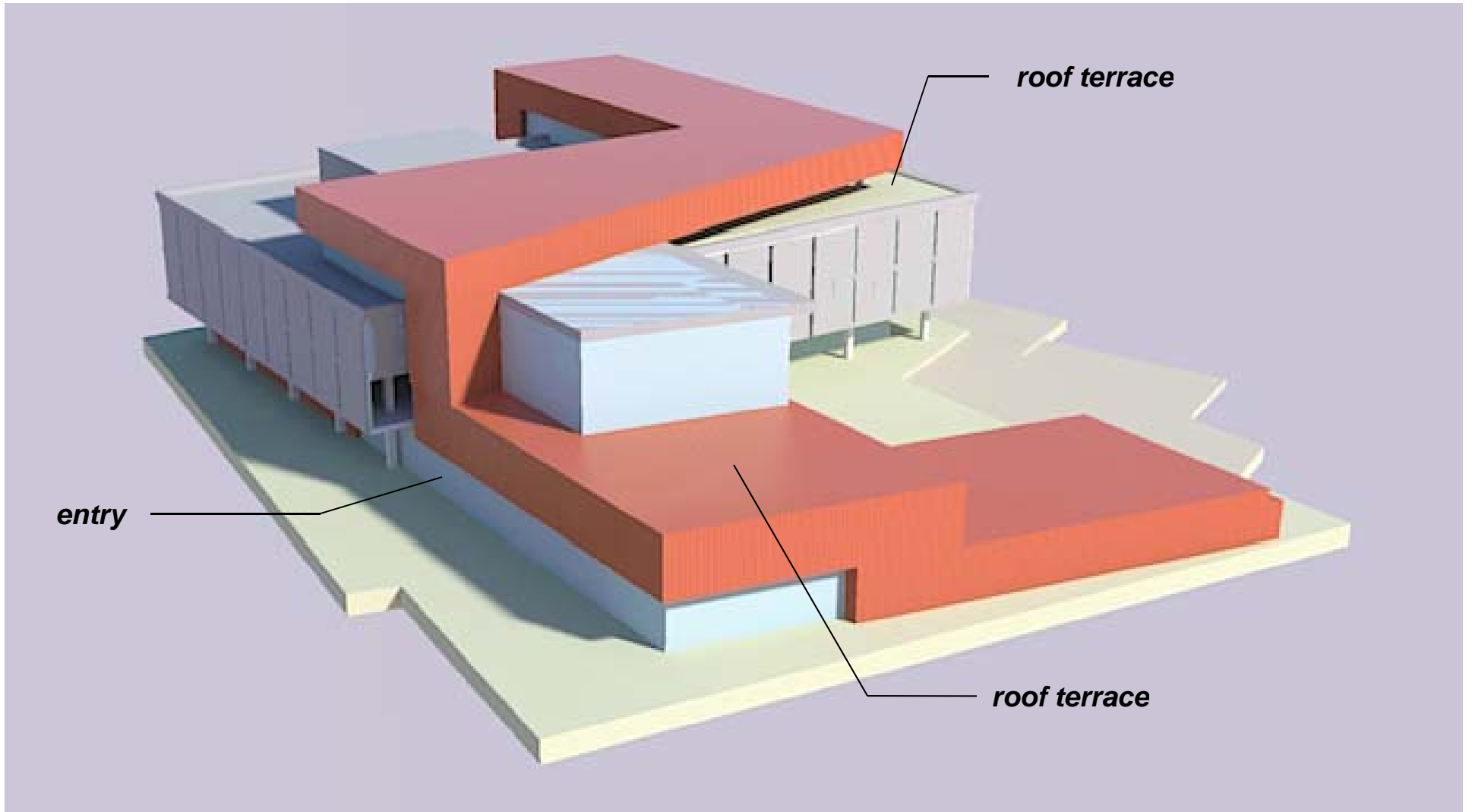

view from northwest

questions/thoughts?